

LAME PER SERIE N/NR/NS/NW

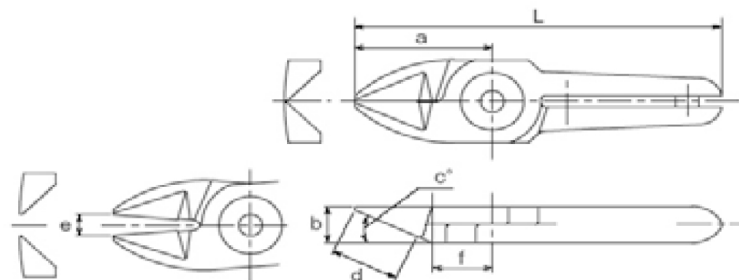

Codice	Corpo	Tipo	Capacità ø			Dimensioni (mm)						
			Plastica	Plastica dura	Rame	Acciaio	Filo armonico	a	b	c	d	e
N3AS	3	AS			1.0	0.5		24	7	25	12	4
N3HS		HS			1.0	0.5	0.2	24	7	25	12	4
N3AP		AP	2.0					24	7	15	11,5	4
N3AE		AE	2.0					20	7	0	7	3,5
N3BJ		BJ				1.0	0.5		24	7	0	13
N5AS	5	AS			1.0	0.5		24	7	25	12	4
N5HS		HS			1.0	0.5	0,3	24	7	25	12	4
N5AP		AP	2.0					24	7	15	11,5	4
N5AE		AE	2.0					20	7	0	7	3,5
N5BJ		BJ				1.0	0.5		24	7	0	13
N7AS	7	AS			1.6	1.0		27	9	30	13,5	4
N7HS		HS			1.6	1.0	0,4	27	9	30	13,5	4
N7AP		AP	3.0	2.0				27	9	30	13	4
N7PF		PF	3.0	2.0				27	9	40	10,5	4
N7AE		AE	3.0	2.0				26	9	0	9	4
N7BJ	BJ				1.6	1.0		27	9	0	13	5
N10AS	10	AS			1.8	1.2		27	9	30	13,5	5
N10HS		HS			1.8	1.2	0,5	27	9	30	13,5	5
N10AP		AP	4.0	2.6				27	9	30	11,5	5
N10LAS	10L	AS			1.8	1.2		35	12	30	20	5
N10LAP		AP	4.0	2.6				35	12	15	16	5
N10LPF		PF	4.0	2.6				35	12	40	13,5	5
N12AS	12	AS			2.3	1.7		35	12	30	20	5
N12HS		HS			2.3	1.7	0,6	35	12	30	20	5
N12AP		AP	4.5	4.0				35	12	15	16	5
N20AS	20	AS			2.6	2.0		35	12	30	20	9
N20HS		HS			2.6	2.0		26	12	40	10	7
N20AG		AG			2.6	2.0	1	28	12	40	12	7
N20AP		AP	7.0	5.0				35	12	15	16	11
N20AJ		AJ	7.0	5.0				35	12	0	18	11
N20AJL		AJL	6.0	4.0				65	12	0	20	16
N20PF		PF	7.0	5.0				35	12	40	13,5	11
N20AE		AE	7.0	5.0				28	12	0	12	8
N20BFB	BFB			2.6	2.0	1.2	35	12	0	17	8	
N30AS	30	AS			3.3	2.8		43	17	30	25	9
N30AG		AG			3,3	2,8		36	17	40	18	7
N30BBB		BBB			3.3	2.8	1.2	36	17	40	18	7
N30AP		AP	10	6,5				66	17	15	38	16
N30AJ		AJ	10	6,5				52	17	0	28	11
N30AJL		AJL	8	5				75	17	0	25	19
N30PF		PF	10	6,5				58	17	30	25	15
N30AE		AE	10	6,5				45	17	0	17	12
N30AEL	AEL	10	6,5				93	17	0	17	21	
N30ACD	ACD	(terminali)	1.25/2.0				40	17	0			
N50AS	50	AS			5.5	4.5		60	25	0	30	11
N50BBB		BBB			5.5	4.5	2.0	46	25	35	19	9
N50ABH41		AP	18	8				119,5	25	30	37	29

Nota: disponibili molte altre lame codificate 'quasi standard' e 'a disegno'
 Dettagli e disegni alla pagina: <http://www.vessel.co.jp/english/product/airnipper/>